

Knight Shadow™ .50

Action: In-Line Break Action, Ambidextrous, Removable Stainless Steel Breech Plug.

Ballistics/Recommended Loads: (See page 11)

Barrel: 26" Green Mountain Rifle Barrel, Alloy or Stainless Steel, 1:28 Twist, .50 caliber

Ignition: 209 Primer

Included In Package: Hex Head Combo Tool, Plug Screws, .50 Cal. Jag and Extension, Sample Bullets, Hammer Spur and Owners Manual.

Length And Weight: 42 Inches, 7.0 Pounds

Loading: General (See page 7)

Powder: Black Powder Ffg, Pyrodex RS", Pyrodex® Select, Triple 7, Pyrodex Pellets.
(Maximum Powder Charge) 150 Grains by Volume, in loose Ffg or the pelleted powder Ffg.

Recommended Scope Mounts: See through #900790, Weaver Ring/Base Sets, #900775, #900776, Redfield Ring/Base Sets #900730, #900731, and One Piece Base and Rings #900777.

Sights: Fully Adjustable Metallic Red Fiber Optic Rear Sight and a one piece Green Fiber Optic Bead and base. Receiver drilled and tapped for easy scope mounting.

Stocks: Forearm and Rear stock Composite

Warranty: Limited Lifetime with extended service policy. See page 52.

Receiver Hole Spacing For Scope Base Mounting

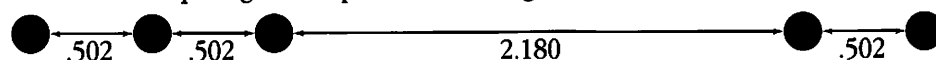

Knight Shadow™ .50

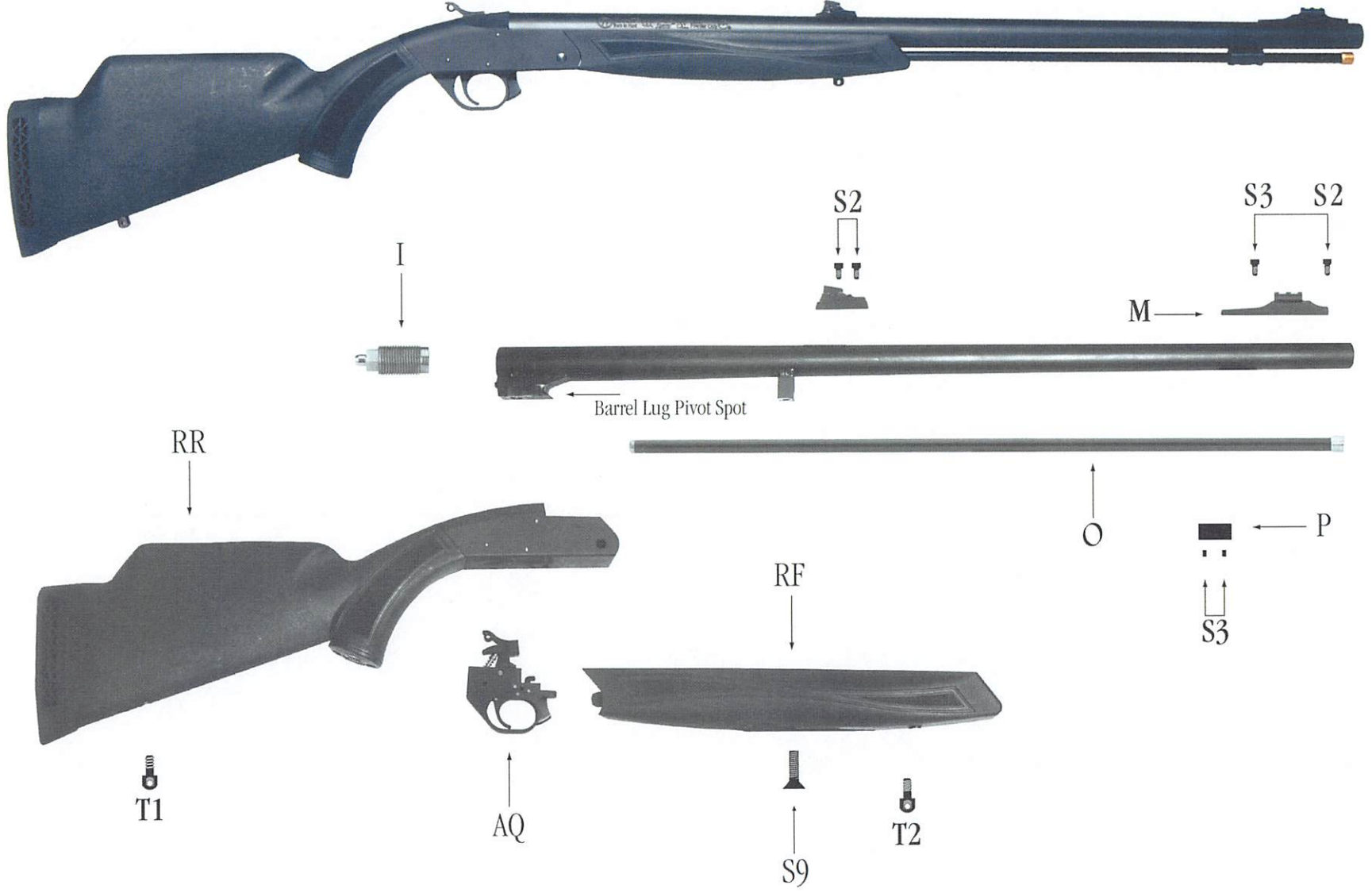

Knight Shadow™ .50

Safety System

The Knight Shadow utilizes an automatic rebound hammer.

Disassembly and Assembly

⚠️ WARNING Be sure rifle is not loaded or primed before disassembly or assembly.

Study the rifle schematic and acquaint yourself with the different parts and terminology of your muzzleloader before assembling or disassembling. Letters and numbers in parentheses refer to labels on each rifle schematic for each model.

It is advisable to use a padded vise to remove and reinstall the breech plug. Place small parts in a pan to avoid losing them.

Disassembly

1. Check the hammer position to ensure the rifle is not cocked or in a unsafe mode (*Figure 1*).
2. Remove ram rod
3. Hold the rifle by the rear stock and point in a safe direction compress the breech lock release button located forward of the trigger guard (*Figure 2*). Allow action to open to inspect the breech and to verify there is no priming device inserted. (*Figure 3*).
4. Remove the breech plug. Insert the combo tool (breech plug wrench side) into the barrel breech, engage the plug (*Figure 4*) and turn it counterclockwise until it slides out of the barrel breech. If more force is required, a hole in the combo tool allows for the use of a rod for added leverage. Put the plug in a jar of Knight solvent for a few minutes while cleaning the barrel.
5. Remove the forearm stock. By using the screwdriver end of the combo tool, take out the stock screw located on the underside of the stock (*Figure 5*). The stock and barrel easily separate.



Figure 1

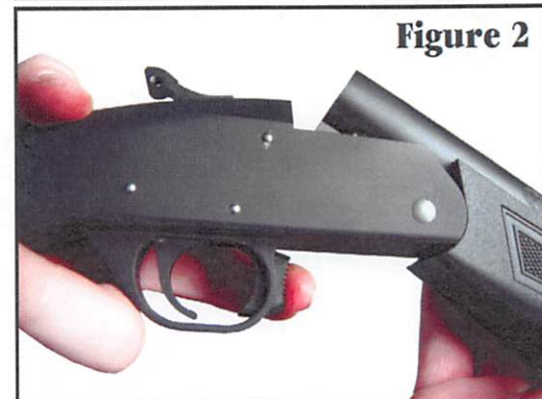

Figure 2

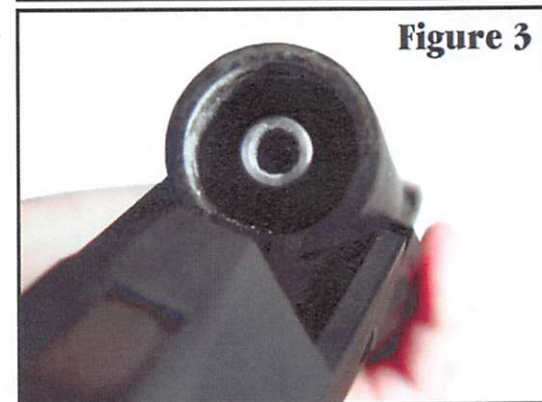

Figure 3



Figure 4

6. Remove the barrel by pulling up and back until it releases itself from the pivot pin located in the receiver (*Figure 6*). This is the only disassembly required.

Knight Shadow™ .50

Assembly

1. Install the breech plug. Fill the threads of the plug with Knight Breech Plug Grease to help prevent the breech plug sticking in the barrel. Using the breech plug end of the combo tool, insert the breech plug into the rear of the barrel and hand tighten the plug into the barrel (*Figure 7*). Be sure the breech plug is screwed all the way into the barrel. Do not over tighten the plug or it will become difficult to remove.

2. Holding the receiver / stock assembly replace the barrel by aligning the barrel lug's pivot slot with the receiver pivot pin and rotate the barrel upward until locked in place (*Figure 8*).

3. Put the forearm stock up against the bottom of the barrel and slide it down onto the receiver (*Figure 9*). Using the screwdriver end of your combo tool, firmly reattach the stock screw through the forestock into the stock lug on the barrel.

4. Replace ram rod

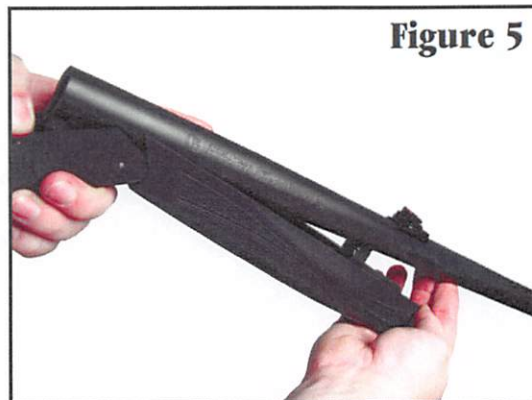

Figure 5



Figure 6

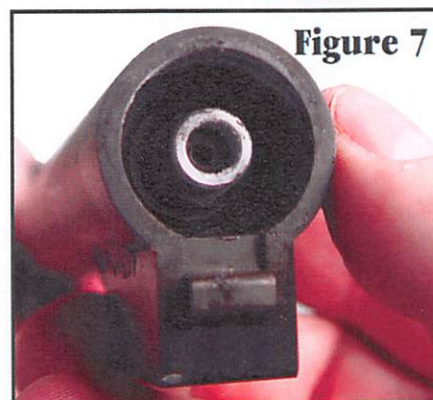

Figure 7

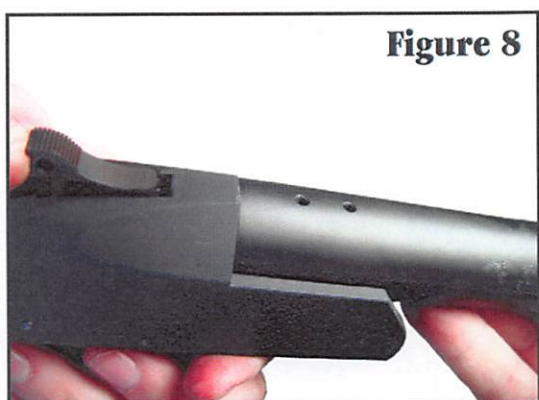

Figure 8

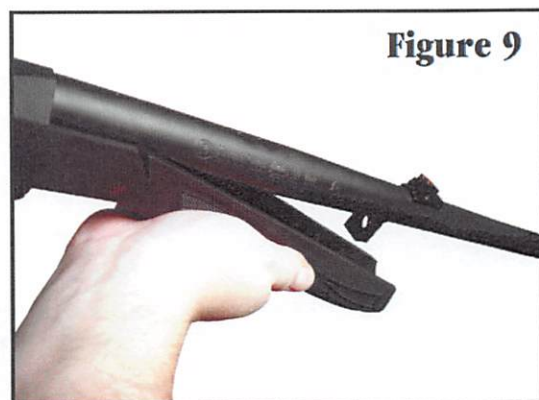

Figure 9

Knight Shadow™ .50

Part Ref.	Model No.	Description
	090325	Barrel Ass'y W/Lug Blued Knight Shadow
	000302	Barrel .50 Cal. 26" Alloy
	000175	Breech Lock
	000195	Breech Lock Spring
	000134	Firing Pin Retain. Set Screw 10-32 Thread
	008805	Front Sight
	008814	Rear Sight
	010030	Sight Screws 6-48 x .260 (3X)
	010020	" " 6-48 x .160 Devalued (3X)
	000890	Molded Ramrod Guide
	000617	Breech Plug 11/16-20 Non-FPJ
	090044	Forearm Assembly Knight Shadow
	004426	Forearm Composite
	000145	Ram Rod Retainer
	000147	Swivel Stud
	010210	Forearm Retaining Screw 1/4-20 x 1
	097100	Receiver Assembly
	007100	Receiver
	000176A	Knurl Pin 1/8 x 1-7/16-Blued Finished Part
	000176	Knurl Pin 1/8 x 1-7/16 (3X)
	000177A	Knurl Pin .315 x 1.437-Blued-Finished Part
	000177	Knurl Pin .315 x 1.437 (1)
	097300	Breech Face Insert Assembly
	000181	Breech Face Insert
	000182	Firing Pin
	000789	Firing Pin Retaining Spring
	000553	Extractor Retaining Set Screw
	000657	3/32 x 3/4 Roll Pin (Slotted)
	097200	Firegroup Assembly
	007200	Trigger Guard
	000193	Dowel Pin, 3/16 x 5/8 (1)
	000192	Dowel Pin, 1/8 x 5/8 (3X)
	000183	Trigger
	000179	Sear
	000753	Trigger Sear Pin Knight Shadow/KRB
	000804	Trigger Return Spring
	000178	Hammer
	000191	Hammer Push Rod
	000190	Hammer Return Spring
	000180	Pivoting Breech Bar
	000194	Decocker Spring
	090045	Rear Stock Assembly
	004427	Rear Stock
	000198	1/4-20 x 2 Socket Head Cap Screw Blk. Ox.
	000170	Flat Washer 17/64 ID x 9/16 OD

008436 Grip Cap
010140 Grip Cap Screws (2X)
010160 Swivel Stud
010267 Recoil Pad
000171 #8 x 1" Wood Screws (2X)
090292 Accessory Kit Knight Shadow
090976 Combo Tool, Blued
008205 Hammer / Rolling Block Spur
000197 Sear Spring .180 x 1.000
010081 Ramrod 24" Standard
010111 Ramrod Insert A
010112 Ramrod Insert B
010114 Ramrod Shaft 23.45"